

37 pieces 40W Bee's Eye specification



1. Remove the packaging

For proper and safe use, please read the instructions carefully before installing and using this product. This specification contains important installation and application information. Please strictly follow the operation procedures when installing.

2. Safety instructions

pay attention to!

Please be careful before operating this product, this product is high voltage product, if contact wire may be electric shock!

This product is a good product before delivery. In order to keep the product in good condition and ensure safe operation, users should follow the safety matters and the instructions.

 Important: Damage caused by not following this instruction is not covered by the warranty. The supplier is not responsible for the product problems arising from this.

If the product has been exposed to extreme unstable temperature conditions (e. g., after transportation), do not supply the product immediately because water drops due to temperature changes may damage the product. Please use the product has returned to normal temperature.

This product can be used in the 90-240V voltage range and is intended for indoor use. Please ensure that the ground voltage is not higher than the tolerable range of the product!! The power plug must be plugged into a protective class I socket. Green or tea-cyan conductors must be grounded.

Please check the product-level power cord frequently. Ensure that the power cord is not folded or damaged and not connected to other wires! Special attention is required when connecting the power cord or the related wiring. Unplug the power supply without using the product or before cleaning.

Before using the product, please be familiar with the operation function of the product. Please do not expose children or no professionals to the product.

Please do not shake this product. Do not use brute force when installing or operating the product. Do not allow unprofessionals to operate the product. Most of the damage is caused by an unprofessional operation.

The product is not equipped with relevant repair accessories. Product maintenance and repair can only be carried out by professionals!

Please do not change this product without authorization, otherwise the product may be damaged, so the damage caused is not covered by the warranty. Also, unprofessional operations can lead to short circuits, burns or electric shocks, and so on.

3. Operating instructions

- -This product is a head dyeing beam lamp used to create dyeing performance.
- -If the product after a large temperature difference (for example, after transportation), do not immediately start the product, because the heat account cold shrinkage will damage the product. Please wait until the device reaches the normal room temperature before starting the product.
- -Pay attention to the shock shock. Avoid strong collisions during product installation.
- -Please do not raise the whole product through the lamp head, because the mechanical nature of the equipment may be damaged.
- -Make sure the product is not exposed to overheated, wet, or dusty places. Please do not place any wires on the ground or you may be in danger of suffering an electric shock.
- -Before installing the product, please ensure the installation point of safety
- -Please attach the product to the safety rope and check that all the screws are correct during installation
- -Please make sure that the lens is in good condition. Replace the lens when the lens is damaged or scratched.
- -It is recommended that the technicians familiar with the product operate the product. Non-technical personnel are prohibited from operating this equipment because many losses are the result of non-professional operations.
- -Please keep the packing materials properly for secondary transportation as required.
- -Do not change the product without the guidance from the manufacturer or distributor.
- -Any equipment failure caused by failing to use the equipment is not covered by the warranty. And any accident caused by short circuit, injury, electric shock, ultraviolet light caused by injury, bulb explosion accidents are not within the scope of warranty.

4. Product hanging and installation

Note: For more safety, install this product away from the walkway, seating area, or accessible area

Before hanging the product, ensure that the installation point supports 10 times the weight of the product.

Product installation must have a double protection device, such as a safety rope.

When hanging, removing or repairing the product, it is forbidden to stand under the installation point.

Please ensure that this product should be installed at least 0.5 meters away from the flammable materials.

Please remember to use the safety rope as a safety guarantee, in case the accident is dropped quickly.

Hanging point: the top hanging requires that the installation personnel must be experienced, including calculating the load-bearing requirements, the installation materials used, and the periodic inspection of the safety status of the installation materials and products. If you lack this knowledge, please do not try to install it yourself. If not incorrectly, it may lead to serious consequences such as personal injury.

Make sure that all the required hanging and installation steps are completed before the product is powered on.

Quick lock hanging: there are specially designed professional pendants at the bottom of this product, including quick lock pendant and safety rope hanging points (please refer to the figure below).

When hanging this product to the truss, please remember to use a suitable quick lock, fix it to the quick lock pendant position of the product, and hang it with the screws of M10. To further ensure the safety, please install the safety rope to the safety rope hanging point at the bottom of the product, and fix it to the truss.

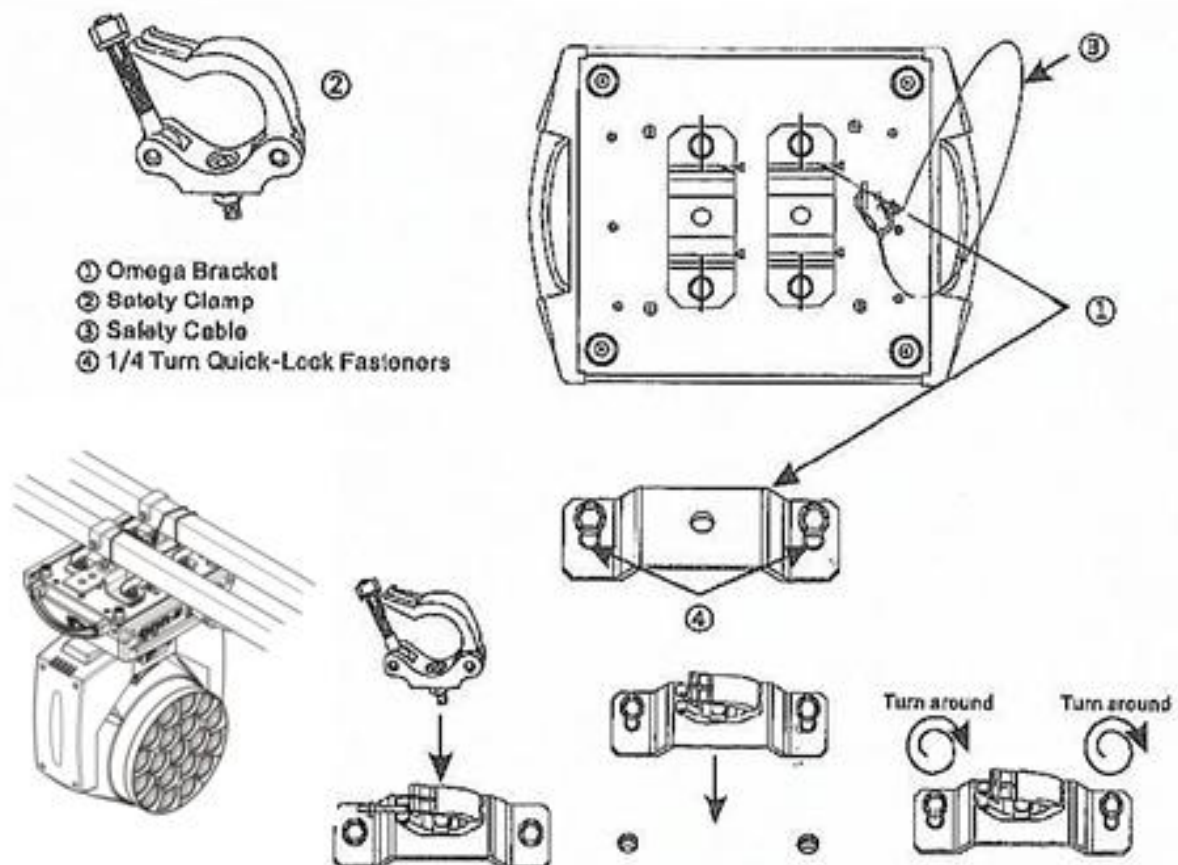

Whatever hanging you choose, please remember to use a safety rope. The bottom of the product is equipped with a special safety rope hanging point, please refer to the above figure, and please remember to use the specially provided safety rope hanging point, do not put the safety rope in the handle position.

6.DMX-512 linkage

Please plug the male header of the XLR signal line into the signal output port of the controller and the master head into the signal input port on the back board of the product. You can talk about multiple products in series, the signal line needs to be three-heart, shielded, with XLR input and output head. Please refer to the figure below.

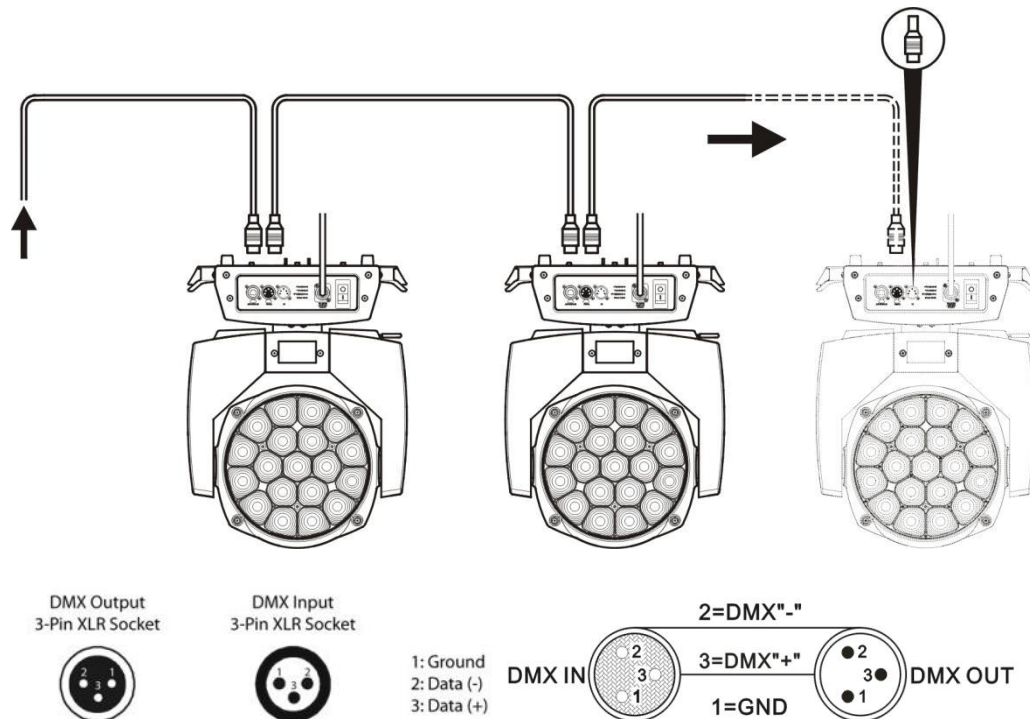

DMX-512 connection with terminal (loop connection)

During installation, a DMX terminal (loop connection) is recommended if the signal line is laid over a long distance, or in noisy electrical environments, such as dance halls. This avoids the digital control signal opacity due to electrical noise. The DMX terminal consists of a simple XLR connector 2 and 3 cores connecting a 120 ohm resistance. Please insert the terminal into the XLR output port of the last product, please refer to the following figure.

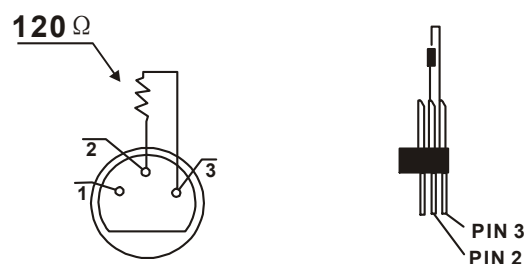

7. Menu

menu		Sublevel menu	Three-level menu / parameters
Shortcut menu interface		return	Return to the main interface
		centre /EN	In / English
		Is showing	The display screen is flipped
		set up	Enter the Setup interface
Set the interface	System Settings	work pattern	Artnet / DMX / Artnet + DMX / self-walking 1 / self-walking 2 / voice control
		channel pattern	22CH/36CH/133CH/147CH /170CH
		Default position of X axis	000-255
		Default position of Y axis	000-255
		X axis reversal	Open / close
		Y axis reversal	Open / close
		XY axis exchange	Open / close
		The XY-axis fast mode	Open / close
		The signal to keep	Open / close
		Optical coupling error correction	Open / close
		Hall error correction	Open / close
		Quick dimming	Open / close
		Backlit time	15s / 30s / 60s / bright
		The dimming curve	Curves 1-4
		Lighting mode	Pass / 750W / 1000W / 1200W / 2000W / 2500W
		factory data reset	Confirm / cancel
	manual	Manual control of	000-255

	mode	the channel values	
	system calibration	enter password	Lighting calibration
	senior	Go back to the next level	
		network (IP/MS)	Increase, decrease, and determine
		Package (Net (0-127)) / Sub _ Uni	Increase, reduce
		Light head reset	
		XY reset	
		Full reset	
	system info	Reset information	Display the specific information and content
		And DMX data detection	Display the specific DMX detection content
		sensor information	Display the optical coupling, Hall specific information
		Hardware version	Displays the hardware version number
		software release	Displays the software version number

➤ **Screen automatic rotation function**

The system can automatically rotate the screen according to the direction of gravity, without manual rotation. You can also turn off the automatic rotation function.

➤ **manual control**

This interface is used to control the current lamp, as detailed in the channel table.

Press OK to enter the edit state. Press Up and Down to change the channel value. Press OK again to save the modified value, exit editing, and press Exit not to save the modified value, and directly exit editing.

➤ **system calibration**

Here to set a layer of password to prevent non-professionals from misoperation. Press OK to verify the password.

option	explain
--------	---------

Initial position calibration	After entering the sub-interface, the reset position of X axis, Y axis, focusing and rotation can be adjusted to make up for the error in hardware installation. The adjustment range of 0~255,127 means no adjustment.
white balance CAL	Adjustable light and LED1-37 red, green, blue, white power, adjustment range 0~255,255 means no adjustment.
calibration of power	The maximum power of the adjustable whole lamp, and the adjustment range of 0~255,255 means no adjustment.
Sound control sensitivity	Adjust the sound-control sensitivity.
change password	Set the system calibration password.

➤ **senior**

Press Up and Down to switch the reset mode, and press OK to reset directly.

option	explain
network (IP/MS)	Increase, decrease, and determine
Package (Net (0-127)) / Sub _ Uni	Increase, reduce
Light head reset	Focal adjustment, rotating motor reset
XY reset	XY axis reduction
Full reset	Lamps reset

◆ **system info**

option	explain
Reset the error message	If the red ERR indicator is illuminated, the lamp is running wrong: 1) IC1 communication fault (communication failure between motor and display board) 2) X / Y optical coupling error reporting 3) Focus adjustment and rotation reset failed
And DMX data monitoring	From this, you can enter the subinterface to display the channel values for viewing and turn the page

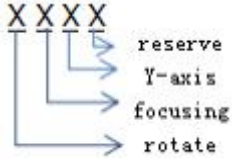
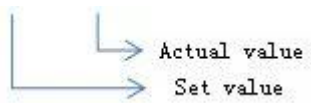
sensor information	<p>1) Hall:</p>  <p>2) sensor:</p> <p>X and Y optical coupling: <u>XXXX</u>--<u>XXXX</u></p> 
Hardware version number	<p>Lighting hardware information</p> <p><u>XX</u> . <u>XX</u> . <u>XX</u> .XX</p> <p>↓ ↓ ↓</p> <p>Display board version. Motor version. Lamp version</p>
Software version number	<p>Lamp software version</p> <p><u>XX</u> . <u>XX</u> . <u>XX</u> .XX</p> <p>↓ ↓ ↓</p> <p>Display board version. Motor version. Lamp version</p>

8 .Channel table

22 channel (22CH)	22+RGB channel (133CH)	22+RGBW channel (170CH)	function	DMX numeric value	description
1	1	1	red	0-255	Red for linear dimming from dark to bright
2	2	2	Red fine tuning	0-255	Red is linearly fine-tuned from dark to bright
3	3	3	green	0-255	Green for linear dimming from dark to bright
4	4	4	Green fine-tuning	0-255	Green is fine-tuned from

					dark to bright
5	5	5	blue	0-255	Blue for linear dimming from dark to bright
6	6	6	Blue fine-tuning	0-255	Blue is linear fine-tuned from dark to bright
7	7	7	white	0-255	White for linear dimming from dark to bright
8	8	8	White fine tuning	0-255	White is fine-tuned from dark to bright
9	9	9	colour temperature	0-255	Linear color temperature regulation
10	10	10	dye	0-255	Built-in color gradient
11	11	11	strobe flash	0-3	lighting-off
				4-103	Synchronous strobe speed from slow to fast (1 HZ-25 HZ)
				104-107	light up
				108-207	Equating strobe speed from slow to fast (1 HZ-25 HZ)
				208-212	light up
				213-225	Low speed random flash
				226-238	Medium speed random flash
				239-251	High-speed random flash
				252-255	light up
12	12	12	Total dimming	0-255	Linear dimming, from dark to bright
13	13	13	Tuning fine-tuning	0-255	Tuning fine-tuning control
14	14	14	X axle	0-255	0-540 degrees
15	15	15	X axis fine-tuning	0-255	The 16bit is adjustable
16	16	16	Y axle	0-255	0-205 degrees

17	17	17	Y axis fine-tuning	0-255	The 16bit is adjustable
18	18	18	function	0-255	obligate
19	19	19	reset	0-25	NF
				26-76	The lamp head reset is valid for 5s
				77-127	The XY reset for 5s is valid
				128-255	All the reset for 5s is valid
20	20	20	focus	0-255	The angle is linearly regulated from small to large
21	21	21	revolve	0-127	0~60 Degrees
				128-188	Counterclockwise from fast to slow infinite turn
				189-193	Rotation stops
				194-255	Cturn from slow to fast
22	22	22	frequency	0-31	1K frequency
				32-63	Frequency of 1.5K
				64-95	2K frequency
				96-127	2.5K frequency
				128-159	3K frequency
				160-191	4K frequency
				192-223	6K frequency
				224-255	10K frequency
	23	23	R1 LED Dimming	0-255	R1 LED Dimming
	24	24	G1 LED Dimming	0-255	G1 LED Dimming
	25	25	B1 LED Dimming	0-255	B1 LED Dimming
		26	W1 LED Dimming	0-255	W1 LED Dimming

	131	167	R37 LED Dimming	0-255	R37 LED Dimming
	132	168	G37 LED Dimming	0-255	G37 LED Dimming
	133	169	B37 LED Dimming	0-255	B37 LED Dimming
		170	W37 LED Dimming	0-255	W37 LED Dimming

36 channel	36+RGB channel (147)	function	DMX numeric value	description
1	1	red	0-255	Red for linear dimming from dark to bright
2	2	Red fine tuning	0-255	Red is linearly fine-tuned from dark to bright
3	3	green	0-255	Green for linear dimming from dark to bright
4	4	Green fine-tuning	0-255	Green is fine-tuned from dark to bright
5	5	blue	0-255	Blue for linear dimming from dark to bright
6	6	Blue fine-tuning	0-255	Blue is linear fine-tuned from dark to bright
7	7	white	0-255	White for linear dimming from dark to bright
8	8	White fine tuning	0-255	White is fine-tuned from dark to bright
9	9	colour temperature	0-255	Linear color temperature regulation
10	10	dye	0-255	Built-in color gradient
11	11	strobeflash	0-3	lighting-off
			4-103	Synchronous strobe speed from slow to fast (1 HZ-25 HZ)
			104-107	light up
			108-207	Equecting strobe speed from slow to fast (1 HZ-25 HZ)

			208-212	light up
			213-225	Low speed random flash
			226-238	Medium speed random flash
			239-251	High-speed random flash
			252-255	light up
12	12	Total dimming	0-255	Linear dimming, from dark to bright
13	13	Tuning fine-tuning	0-255	Tuning fine-tuning control
14	14	X axle	0-255	0-540 degrees
15	15	X axis fine-tuning	0-255	The 16bit is adjustable
16	16	Y axle	0-255	0-205 degrees
17	17	Y axis fine-tuning	0-255	The 16bit is adjustable
18	18	function	0-255	obligate
19	19	reset	0-25	NF
			26-76	The lamp head reset is valid for 5s
			77-127	The XY reset for 5s is valid
			128-255	All the reset for 5s is valid
20	20	focus	0-255	The angle is linearly regulated from small to large
21	21	revolve	0-127	0~60 Degrees
			128-188	Counterclockwise from fast to slow infinite turn
			189-193	Rotation stops
			194-255	Cturn from slow to fast
22	22	Dynamic effect (Mateffect color)	0-7	not have
			8	Static effect 1

			9	Static effect 2
			10	Static effect 3
			11	not have
			12	Static effect 4
			13	Static effect 5
			14	not have
			15	Dynamic effect 1
			16	Dynamic effect 2
			17	Dynamic effect 3
			18	Dynamic effect 4
			19	Monochromatic random
			20	Full color random
			21	Rainbow Effect 1
			22	Rainbow Effect 2
			23	Dynamic effect 5
			24	Dynamic effect 6
			25	Dynamic effect 7
			26	Dynamic effect 8
			27	Dynamic effect 9
			28	Dynamic effect 10
			29	Dynamic effect 11
			30	Dynamic effect 12
			31	Dynamic effects 13
			32	Dynamic effects 14

			33	not have
			34	not have
			35	Dynamic effect 15
			36	Dynamic effects 16
			37	Dynamic effects 17
			38	Dynamic effects 18
			39	Dynamic effects 19
			40	Dynamic effect 20
			41	not have
			42	Dynamic effect 21
			43	not have
			44	Dynamic effect 22
			45	Dynamic effect 23
			46	Dynamic effects 24
			47	Dynamic effect 25
			48	Dynamic effects 26
			49	Dynamic effects 27
			50	Dynamic effect 28
			51	Dynamic effects 29
			52	Dynamic effect 30
			53	Dynamic effects 31
			54	Dynamic effects 32
			55	Dynamic effects 33
			56	Dynamic effects 34

			57	Dynamic effect 35
			58	Dynamic effects 36
			59	Dynamic effects 37
			60	Dynamic effects 38
			61	Random position 1
			62	Random position 2
			63	Random position 3
			64	not have
			65	Random position 4
			66	Random position 5
			67	Dynamic effects 39
			68	Dynamic effect 40
			69	not have
			70	Dynamic effect 41
			71-255	not have
23	23	Dynamic effect speed	0-63	The effect is static
			64-158	Forward from fast to slow
			159-160	static
			161-255	Reverse from slow to fast
24	24	Effects downplay	0-255	Dynamic effect downplay
25	25	The effect is red	0-255	Dynamic effect red
26	26	The effect of green	0-255	Dynamic effect green
27	27	The effect is blue	0-255	Dynamic effect blue

28	28	The effect of white	0-255	Dynamic effect white
29	29	Effect dimming	0-255	Pattern with 0-100% dimming
30	30	Background dimming	0-255	Background with 0-100% dimming
31	31	Effect transition	0-255	Pattern change control
32	32	Effects offset	0-255	Dynamic effect translation
33	33	Prospects flash	0-255	Probe (same as 11 channel)
34	34	Background flash	0-255	Background strobe (same as 11 channel)
35	35	background selection	0-255	background selection
36	36	frequency	0-31	1K frequency
			32-63	Frequency of 1.5K
			64-95	2K frequency
			96-127	2.5K frequency
			128-159	3K frequency
			160-191	4K frequency
			192-223	6K frequency
			224-255	10K frequency
	37	R1 LED Dimming	0-255	R1 LED Dimming
	38	G1 LED Dimming	0-255	G1 LED Dimming
	39	B1 LED Dimming	0-255	B1 LED Dimming

	145	R37 LED Dimming	0-255	R37 LED Dimming
	146	G37 LED Dimming	0-255	G37 LED Dimming
	147	B37 LED Dimming	0-255	B37 LED Dimming

9. Product maintenance and cleaning

Please note the following points when testing this product:

1. All the screws and parts of the installed products must be tightly connected and do not rust.
2. The shell, lens, fixture and installation site (e. g., ceiling, hanger, truss, etc.) cannot be deformed.
3. Mechanical moving parts should not have wear and tear, can not rotate unbalanced.
4. The power cord should not have any damage, material broken skin or scar, etc.

The installation and use of the product must be carried out by trained professional and technical personnel, and must ensure that the safety risks are eliminated.

Note: Please unplug the power cord before product maintenance!!

In order to maintain the product in good condition and extend the service life, we recommend routine cleaning of the product.

1. Clean the external lens and internal lens of the product every week to prevent the light output of the product from weakening due to the dust of the lens.
2. Clean the fan every week.
3. Every three months, professional electrical engineers will check the product in a detailed circuit, to ensure that the circuit contact is good, to prevent the circuit contact from aging due to overheating.

We recommend that the products be cleaned regularly. Please be careful not to use damp or linen, or never use alcohol or solvents.

This product is not equipped with replacement parts, please refer to the "Installation Instructions" section.

If users need any spare parts, please purchase them from any local dealer.